

TTLOCK Fingerprint Access Control

User Manual

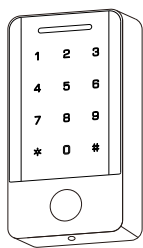

Technology Creates A Better Life

Size

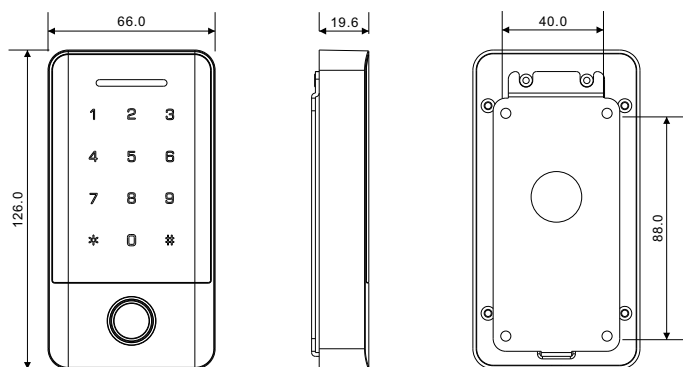

Functions

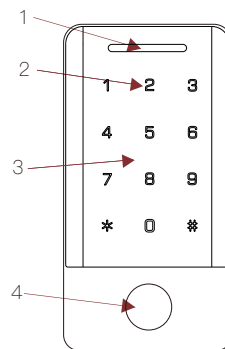

1. Indicator LED
2. Touch keypad
3. Card reading area
4. Fingerprint sensor

Installation

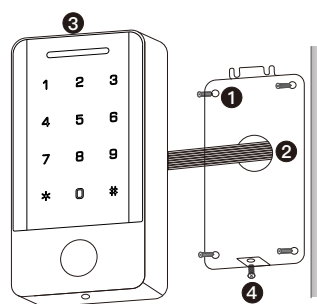

1. Install the back metal plate first by the screws.
2. Pass the cables through the plate hole and connect them correctly.
3. Mount the access control device to the metal plate.
4. Fix the access control bottom screw.

Wiring

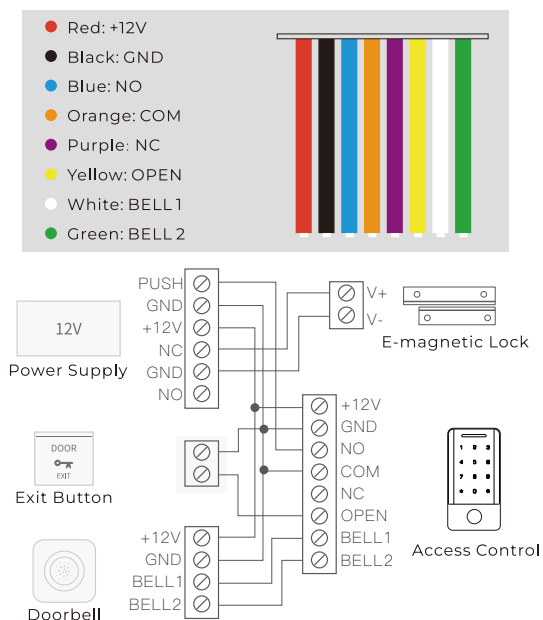

Reset the device

It's suggested to reset the device in the APP. Choose the "setting" menu in the device home page, and then press the "delete" button at the bottom of the setting page. Input the APP user password to delete the device. Or you may press the reset button using a pin into the reset hole under the cable at the back side of the device, press it for more than 3 seconds until the device asks you to input the initialization password. By default it's 000 and then press #.

APP operation



Please scan the QR code to download TTLOCK APP and finish the registration.

1. Touch the keypad to turn on the backlight.
2. Open TTLOCK APP.
3. Press the and add lock. Select the type of all locks.
4. Select the device and wait until it's added.

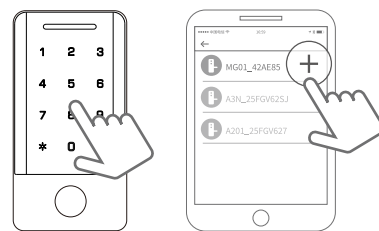

Note: If you can't add the device, you may disable the mobile phone Bluetooth and exit the APP. Then turn on the Bluetooth and open the APP to try again.

Parameter

- Fingerprint capacity:** 100
- Card type:** MIFARE
- Card capacity:** 250
- Password capacity:** 1000
- Unlock method:** Fingerprint, password, card and TTLOCK APP
- Temperature:** -15 ~ 50 celsius degrees
- Power supply:** DC 12V
- Working current:** <200mA